

Delta Surface Horizontal



Self-priming centrifugal pumps with Venturi system up to 9 m



0978 702 058

kinhdoanh@vinabom.com

Applications

To work with clean water.
Irrigation and hydropneumatic sets.

Motor

Asynchronous, two poles.
IP 44 protection.
Class F insulation.
Continuous operation.
Single-phase version with built-in thermal protection.
Provided with removable handle for transport.

Materials

Pump body in stainless steel AISI 304.
Motor shaft in stainless steel AISI 420.
Diffusers in glass loaded Noryl®.
Mechanical seal in graphite and steatite.
Motor housing in aluminium L-2521.
Windings impregnated with epoxy resin.

Delta 505/755/1005:

Impeller in glass loaded Noryl®.

Delta 1755:

Impeller in stainless steel AISI 304.



0978 702 058

kinhdoanh@vinabom.com

Hydraulic performance table

Model	I [A]			P1 [kW]		P2		c [μF]	l/min m³/h	5	15	25	35	40	50	60	75	1~230 V (model M)	3~400 V (model T)	
	1~230 V	3~400 V		1~230 V	3~400 V	[kW]	[HP]											Code	Code	
		230 V	400 V																	
Delta 505	2.8	2.2	1.2	0.6	0.6	0.37	0.5	12	mwc	0.3	0.9	1.5	2.1	2.4	3.0	3.6	4.5	146271	146291	
Delta 755	3.4	2.6	1.3	0.8	0.8	0.55	0.75	12		37	32	27	23	21	17			146270	146309	
Delta 1005	4.8	3.3	1.9	1.0	1.0	0.75	1.0	16		47	40	34	29	27					146018	146061
Delta 1755	5.5	3.8	2.1	1.2	1.2	0.75	1.0	16		57	55	51	47	44	38	32	21			146017

Performance curves at 2900 rpm

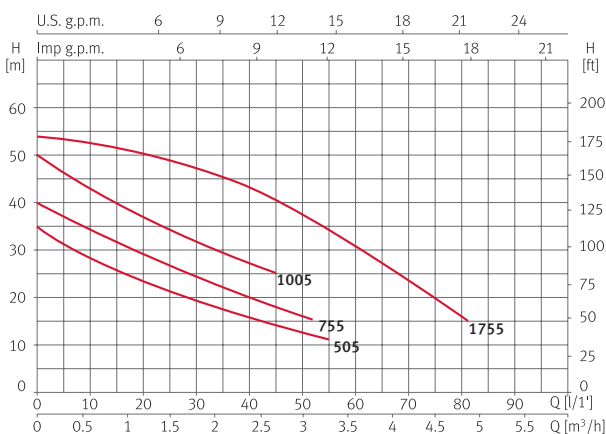

Dimensions and weights

Model	A	B	C	D	E	F	G	H	I	J	K	Kg
Delta 505	336	184	280	200	1"	78	22	215	94	126	147	6.8
Delta 755	336	184	280	200	1"	78	22	215	94	126	147	7.3
Delta 1005	359	184	280	200	1"	78	22	215	94	126	147	9.6
Delta 1755M	410	184	280	200	1"	125	22	215	94	126	147	12.1

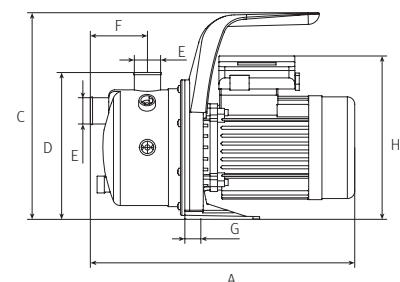
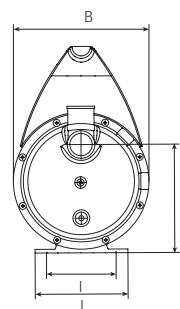

*Service kits are available on request



0978 702 058

kinhdoanh@vinabom.com